

# Automatic Air Maintenance Panel

Series 391-05/6



Model 391-05/6

## Technical Data

### Model Numbers

- 391-05: Includes Pressure Regulator and Accelerator Pilot.
- 391-06: Excludes Pressure Regulator.

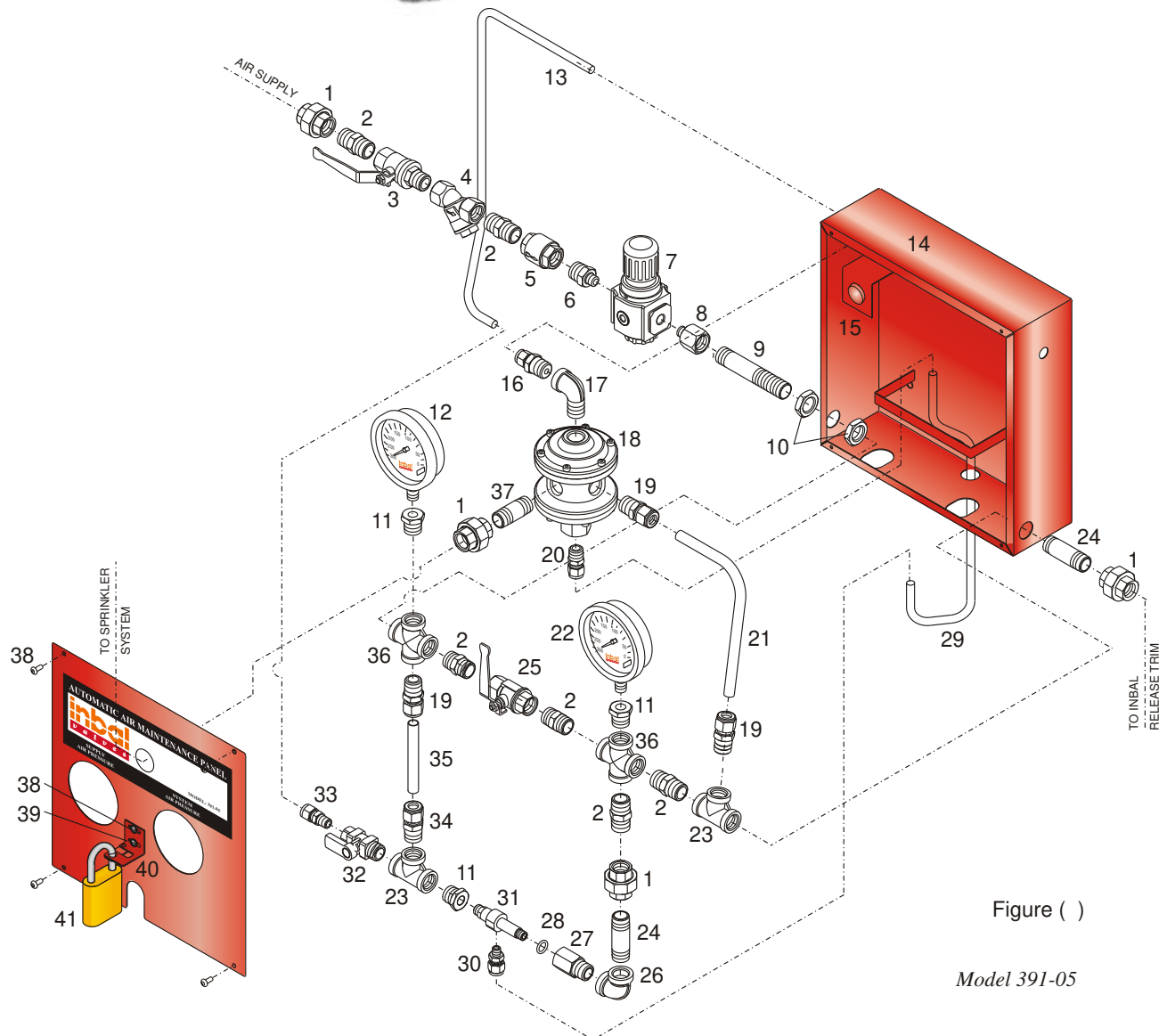

Figure ( )

Model 391-05

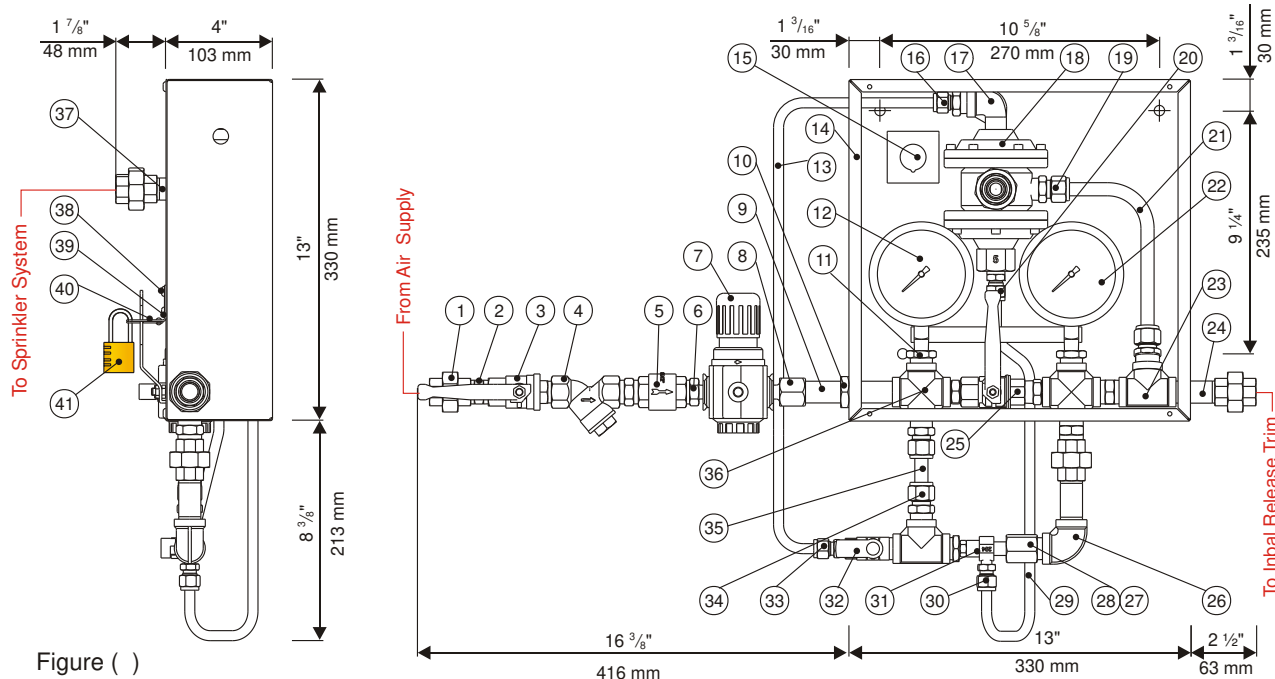

Figure ( )

Item	Model/Cat. No.	Description	Standard Material	Quantity
1	1044B½	Union ½"	Stainless Steel AISI 304	4
2	122½	Hex. Nipple ½"	Stainless Steel AISI 304	6
3	351-08-02	Shutoff Valve ½"	Brass, Nickel Chrome plated	1
4	31-08-02_	Y-Strainer (Screen 25 micron) ½"	Bronze, Nickel Chrome plated	1
5	371-08-02	Check Valve ½"	Brass	1
6	1234B ½ X ¼	Hexagon Nipple ½" x ¼" <sup>a</sup>	Stainless Steel AISI 304	1
7	R11200RNFD	Pressure Regulator <sup>a</sup>	Aluminium Body	1
8		Adapter ½"(F) x ¼"(M) <sup>a</sup>	Stainless Steel AISI 304	1
9		Nipple ½" x 4 ⅜"	Stainless Steel AISI 304	1
10	N4 ½	Nut ½"	Stainless Steel AISI 304	2
11	110B ½ X ¼	Bushing ½" x ¼"	Brass, Nickel Chrome plated	3
12	131-11	Air Supply Pressure Gauge	See bulletin F40-04-01	1
13		High Sensing Tube ⅜"	Stainless Steel AISI 316	1
14		Enclosure Assembly	Stainless Steel AISI 304	1
15	390030	Bulb (24 VDS)	Optional	1
16		Flexible Fitting ½"(M) x OD ⅜"	Brass, Nickel Chrome plated	1
17		Street Elbow ½" x 90°	Stainless Steel AISI 304	1
18	397-08	3-Way Accelerator Pilot	Brass, Nickel Chrome plated	1
19		Flexible Fitting ½"(M) x OD ½"	Brass, Nickel Chrome plated	3
20		Flexible Fitting ⅜" (M) x OD ⅜"	Brass, Nickel Chrome plated	1
21		Air Supply Tube ½"	Stainless Steel AISI 316	1
22	131-11	Air System Pressure Gauge	See bulletin F40-04-01	1
23	101B ½	Tee ½"	Stainless Steel AISI 304	2
24		Nipple ½" x 2.5"	Stainless Steel AISI 304	2
25	351-08-01	Bypass Valve ½"	Brass, Nickel Chrome plated	1
26		Elbow ½"x 90°	Stainless Steel AISI 304	1
27		Adapter for ejector	Brass, Nickel Chrome plated	1
28		0-RING 2-112	BUNA-N	1
29		Low Sensing Tube ⅜"	Stainless Steel AISI 316	1
30		Twin Ferrules Fitting ⅛" (M) x OD ⅜"	Brass, Nickel Chrome plated	1
31	277	Ejector 0.059" (1.5mm)	Brass	1
32	353-08-01	Reset Valve ½"(M) x ¼"(F)	Brass, Nickel Chrome plated	1
33		Twin Ferrules Fitting ¼"(M) x OD ⅜"	Brass, Nickel Chrome plated	1
34		Twin Ferrules Fitting ½"(M) x OD ½"	Brass, Nickel Chrome plated	1
35		Compensating Tube ½"	Stainless Steel AISI 316	1
36		Cross ½"	Stainless Steel AISI 304	2
37		Nipple ½"x 2"	Stainless Steel AISI 304	1
38	A4M5X12	Allen Bolt M5x12	Stainless Steel AISI 304	6
39	N4M5	Nut M5	Stainless Steel AISI 304	2
40		Locking Device	Stainless Steel AISI 304	1
41	%	Locker	Optional	1

<sup>a</sup> - Participates only in models 391-01 & 391-02

# Automatic Air Maintenance Panel

Series 391-05/6



## Piping & Instrumentation Diagram

