

Model 711D-02HME01

Trim Chart - Vertical Installation

Sizes 1½" - 3" (40 - 80 mm)



Inbal Control Valve, Electric Actuation, Standard Material Control Trim

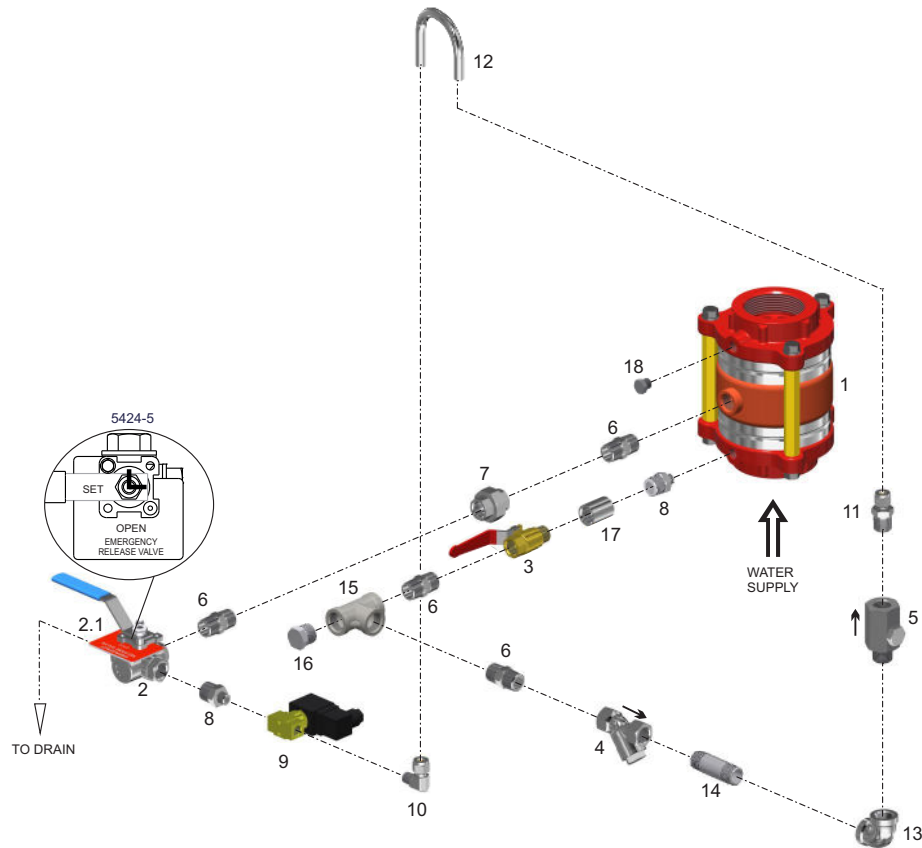

Item	Description	Qty	Material	Cat. No.
1	Inbal Automatic Water Control Valve model 711D	1	See bulletin F02-01	1711D01DDSSSS
2	Emergency Release Valve model 347-08-02	1	See bulletin F40-06	234706008000
2.1	Label	1	P.V.C.	293108010005
3	2-Way Ball Valve ½", series 351	1	See bulletin F40-08	235102008000
4	Y-Pattern Strainer ½", series 31	1	See bulletin F40-03	231006008001
5	Check Valve ½", series 371, MxF	1	See bulletin F40-12	137102008000
6	Hex. Nipple ½"	4	St.St.304	212206008001
7	Union ½" M x F	1	St.St.304	210406008006
8	Red. Nipple ½" x ¼"	2	St.St.304	212206020000
9	Solenoid Valve series 151	1		
10	Twin Ferrules Fitting Elbow ¼"NPT x ⅜"OD	1	Brass, Ni-Cr plated	
11	Twin Ferrules Fitting ½"NPT x ⅜"OD	1	Brass, Ni-Cr plated	318902008000
12	Water Supply Tube ⅜" OD	1	St.St.316	
13	Elbow ½"	1	St.St.304	210006008001
14	Nipple ½", L=2½" (63 mm)	1	St.St.304	212206016001
15	Tee ½"	1	St.St.304	210106008001
16	Plug ½"	1	St.St.304	212106008000
17	Coupling ½"	1	St.St.304	210306008001
18	Plug ¼"	1	St.St.304	212106004000