

Model 799DX-04CR05



FM Trim Overall Dimensions & Weights - Vertical Installation

FM Approved

Inbal Deluge Valve, Pressure Control, Electric Actuation, Local Resetting, Standard Material Control Trim

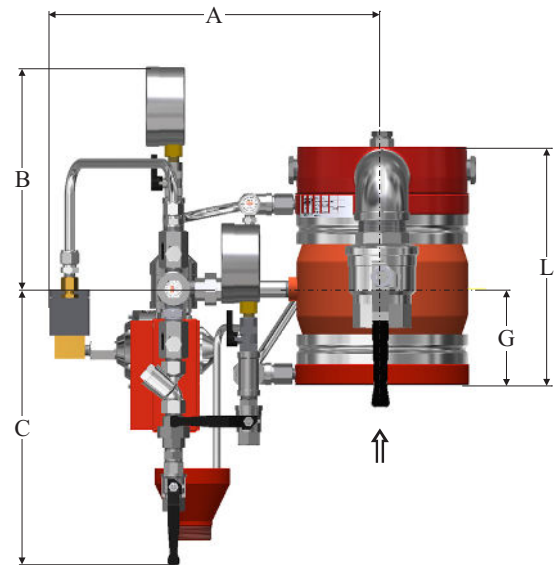
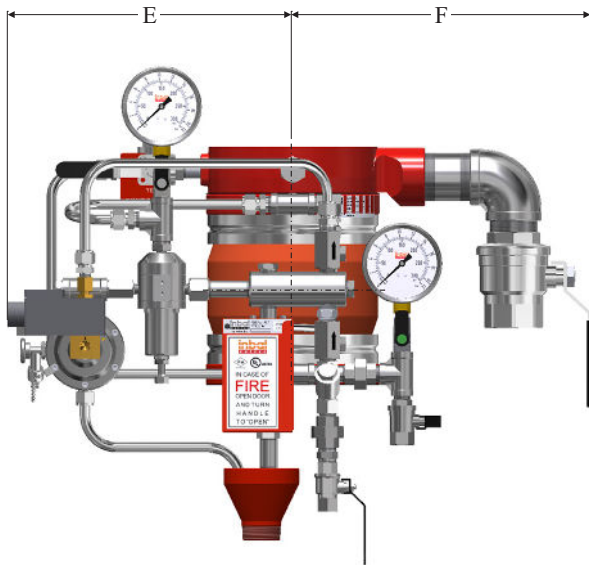

SIZE inches / mm	A	B	C	E	F	G	L	Weight* lbs / kg
3	14 1/8	11	13	14 1/8	13 1/4	3 1/4	8 1/8	69.5 lbs
80	360	280	330	360	335	80	207	31.5 kg
4	14 3/4	11	13	14 1/8	14 1/2	3 3/4	10 1/8	84.5 lbs
100	375	280	330	360	365	95	257	37.0 kg
6	16	11	13	14 1/8	15	4 3/4	11 3/4	106.0 lbs
150	405	280	330	360	375	120	298	48.0 kg
8	17	11	13	14 1/8	15 3/4	6	14 1/4	152.5 lbs
200	432	280	330	360	400	155	362	69.5 kg
10	18	11	13	14 1/8	18 1/4	7	16 1/8	202.0 lbs
250	457	280	330	360	460	175	410	91.5 kg
12	18 1/2	11	13	14 1/8	19 1/4	8 3/4	19 1/8	279.0 lbs
300	473	280	330	360	490	225	503	126.5 kg

* Refer to Standard Material Valve.

Model 799DX-04CR05

FM Trim Chart - Vertical Installation

Inbal Deluge Valve, Pressure Control, Electric Actuation, Local Resetting, Standard Material Control Trim

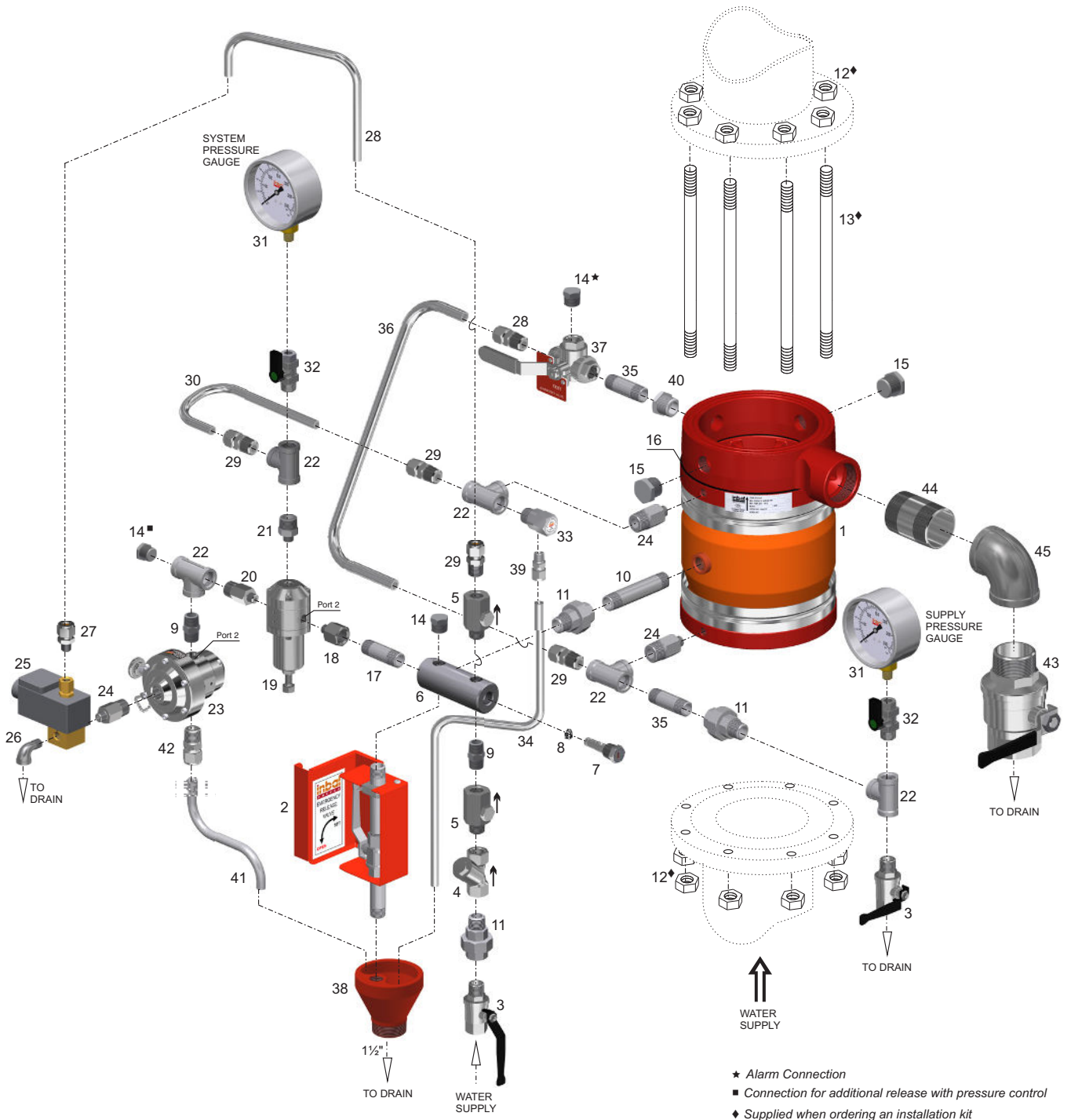

- The bill of materials is available in the next page.
- The alarm piping should be connected to the common port of the Alarm Test Valve. A Water Motor Alarm requires a 3/4" (20 mm) pipe. For an electric Alarm Pressure Switch - a 1/2" (15 mm) pipe can be used. When a Water Motor Alarm is used, a strainer is required.
- The control trim is supplied fully preassembled.
- When the control trim is ordered in loose components form, the Inbal Deluge Valve must be trimmed as shown. Any deviation may affect proper operation.

Model 799DX-04CR05

FM Trim Chart - Vertical Installation



Inbal Deluge Valve, Pressure Control, Electric Actuation, Local Resetting, Standard Material Control Trim

FM Approved

Item	Description	Qty	Material	Cat. No.
1	Inbal Automatic Water Control Valve model 799DX	1	See bulletin F02-03	1799DX01DDSSSS
2	Emergency Release Station model 393-01	1	See bulletin F34-04	239302001002
3	2-Way Ball Valve 1/2", series 351	2	See bulletin F40-08	235102008000
4	Y-Pattern Strainer 1/2", series 31	1	See bulletin F40-03	231006008001
5	Check Valve 1/2", series 371	2	See bulletin F40-12	137102008000
6	Manifold	1	Brass, Ni-Cr plated	322702016000
7 (e)	Restriction Orifice model 12-07-01	1	Brass, Ni-Cr plated	312702009000
(f)	Restriction Orifice model 12-07-02	1	Brass, Ni-Cr plated	312702009001
8	O-Ring 2-109	1	Buna-N	270621090000
9	Hex. Nipple 1/2"	2	St.St.304	212206008001
10	Nipple 1/2", L=4" (102 mm)	1	St.St.304	212206018001
11	Union 1/2" M x F	3	St.St.304	210406008006
12	Nut	(a)	Galvanized Steel	22420101DDDD
13	Stud Bolt	(a)	Galvanized Steel	226001RRRRRR
14	Plug 1/2"	3	St.St.304	212106008000
15	Plug 3/4"	2	See note (b)	212106012000
16	Gasket. Thickness: 1/16" (1.6 mm)	1	Fiber	270709DDDD000
17 (e)	Nipple 1/2", L=3" (76 mm)	1	St.St.304	212206005000
(f)	Nipple 1/2", L=4" (102 mm)	1	St.St.304	212206018001
18 (e)	Adapter 1/4"M x 1/2"F	1	St.St.304	312006003001
19 (e)	Pressure Reducing Pilot Valve model PA1	1	See bulletin F36-02	1PA102001000
(f)	Pressure Reducing Pilot Valve model PB1	1	See bulletin F36-02	1PB102001000
20 (e)	Red. Nipple 1/2" x 1/4", L=2" (51 mm)	1	St.St.304	212306012001
(f)	Nipple 1/2", L=2" (50 mm)	1	St.St.304	212206003000
21 (e)	Red. Nipple 1/2" x 1/4"	1	St.St.304	212206020000
(f)	Hex. Nipple 1/2"	1	St.St.304	212206008001
22	Tee 1/2"	5	St.St.304	210106008001
23	Deluge Pilot Valve model 290-08	1	See bulletin F33-02	129002008000
24	Red. Nipple 1/2" x 1/4", L=2" (51 mm)	3	St.St.304	212306012001
25	Solenoid Valve model 151-61	1		215102061000
26	Street Elbow 1/4"	1	St.St.304	211606004001
27	Twin Ferrules Fitting 1/4"NPT x 1/2"OD	1	Brass, Ni-Cr plated	318902009000
28	Operating Tube 1/2"OD	1	St.St.316	994006008000
29	Twin Ferrules Fitting 1/2"NPT x 1/2"OD	5	Brass, Ni-Cr plated	318902007000
30	Pressure Sensing Tube 1/2"OD	1	St.St.316	994006008000
31	Pressure Gauge	2	See bulletin F40-04	213106041002
32	Pressure Gauge Valve 1/2" x 1/4"	2	See bulletin F40-09	235302008001
33	Automatic Drain Valve model 373-08	1	See bulletin F40-13	137302008000
34	Drain Tube 3/8" OD	1	St.St.316	994006060000
35	Nipple 1/2", L=2 1/2" (63 mm)	2	St.St.304	212206016001
36	Alarm Test Tube 1/2"OD	1	St.St.316	994006008000
37	Alarm Test Valve model 347-08-02	1	See bulletin F40-06	234706008000
38	Drain Cup	1	Steel, Epoxy coated	397000000000
39	Tube Fitting 1/4"NPT x 3/8"OD	1	Brass, Ni-Cr plated	314002003000
40	Bushing 3/4"M x 1/2"F	1	See note (b)	211006002005
41	Drain Tube 1/2"OD	1	St.St.316	994006008000
42	Tube Fitting 1/2"NPT x 1/2"OD	1	Brass, Ni-Cr plated	314002008000
43 (c)	2-Way Ball Valve 1 1/2", series 351	1	See bulletin F40-08	235102040000
(d)	2-Way Ball Valve 2", series 351	1	See bulletin F40-08	235102050000
44 (c)	Nipple 1 1/2", L=3 1/4" (83 mm)	1	St.St.304	212206001000
(d)	Nipple 2", L=3 1/4" (83 mm)	1	St.St.304	212206009001
45 (c)	Elbow 1 1/2"	1	See note (b)	210006024001
(d)	Elbow 2"	1	See note (b)	210006032001

Notes: (a) Supplied when ordering an installation kit. Quantity and thread standard for Stud Bolts and Nuts may vary, depending on Inbal Valve size and flange standard.
 (b) Brass, Ni-Cr plated or Stainless Steel AISI 304.
 (c) For 3" (80 mm) Inbal Valves.

(d) For 4"; 6"; 8"; 10" & 12" (100; 150; 200; 250 & 300 mm) Inbal Valves
 (e) For 3" & 4" (80 & 100 mm) Inbal Valves.
 (f) For 6"; 8"; 10" & 12" (150; 200; 250 & 300 mm) Inbal Valves.