

# Model 733DX-03C06

FM & UL Trim Overall Dimensions & Weights - Vertical Installation



v a l v e s

Inbal Deluge Valve, Electric Actuation, Remote Resetting, Standard Material Control Trim

FM Approved

UL Listed

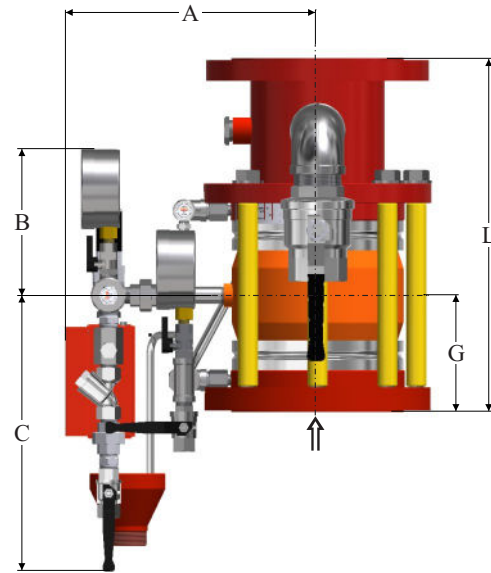
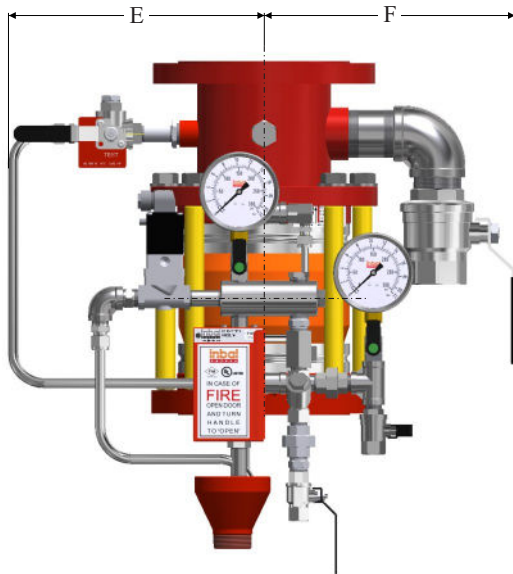

SIZE inches / mm	A	B	C	E	F	G	L	Weight* lbs / kg
2	10 ¾	7 ½	13	11 ½	7 ½	4 ½	12	92.0 lbs 41.5 kg
50	275	185	330	290	185	115	307	41.5 kg
2 ½	10 ¾	7 ½	13	11 ½	10 ½	4 ½	13 ⅞	94.0 lbs 42.5 kg
65	275	280	330	345	265	115	335	42.5 kg
3	10 ¾	7 ½	13	11 ½	10 ½	4 ¼	12 ¾	87.5 lbs 39.5 kg
80	275	185	330	290	265	105	325	39.5 kg
4	11 ¼	7 ½	13	12	11 ½	4 ¾	14 ¾	116.0 lbs 52.5 kg
100	290	280	330	345	295	120	375	52.5 kg
6	12 ½	7 ½	13	13	12 ½	6	17 ½	128.0 lbs 58.0 kg
150	315	185	330	330	315	150	444	58.0 kg
8	13 ½	7 ½	13	14	13 ½	7 ¼	20	235.0 lbs 106.5 kg
200	345	185	330	355	345	180	508	106.5 kg
10	14 ½	7 ½	13	15 ¼	14 ¾	8 ¼	22 ½	327.5 lbs 148.5 kg
250	370	185	330	385	375	210	572	148.5 kg
12	15 ¼	7 ½	13	16 ½	16	10	25 ⅞	453.5 lbs 205.5 kg
300	385	185	330	420	410	255	657	205.5 kg

\* Refer to Standard Material Valve.

# Model 733DX-03C06

## FM & UL Trim Chart - Vertical Installation

Inbal Deluge Valve, Electric Actuation, Remote Resetting, Standard Material Control Trim

**inbal**  
v a l v e s

FM Approved  
UL Listed

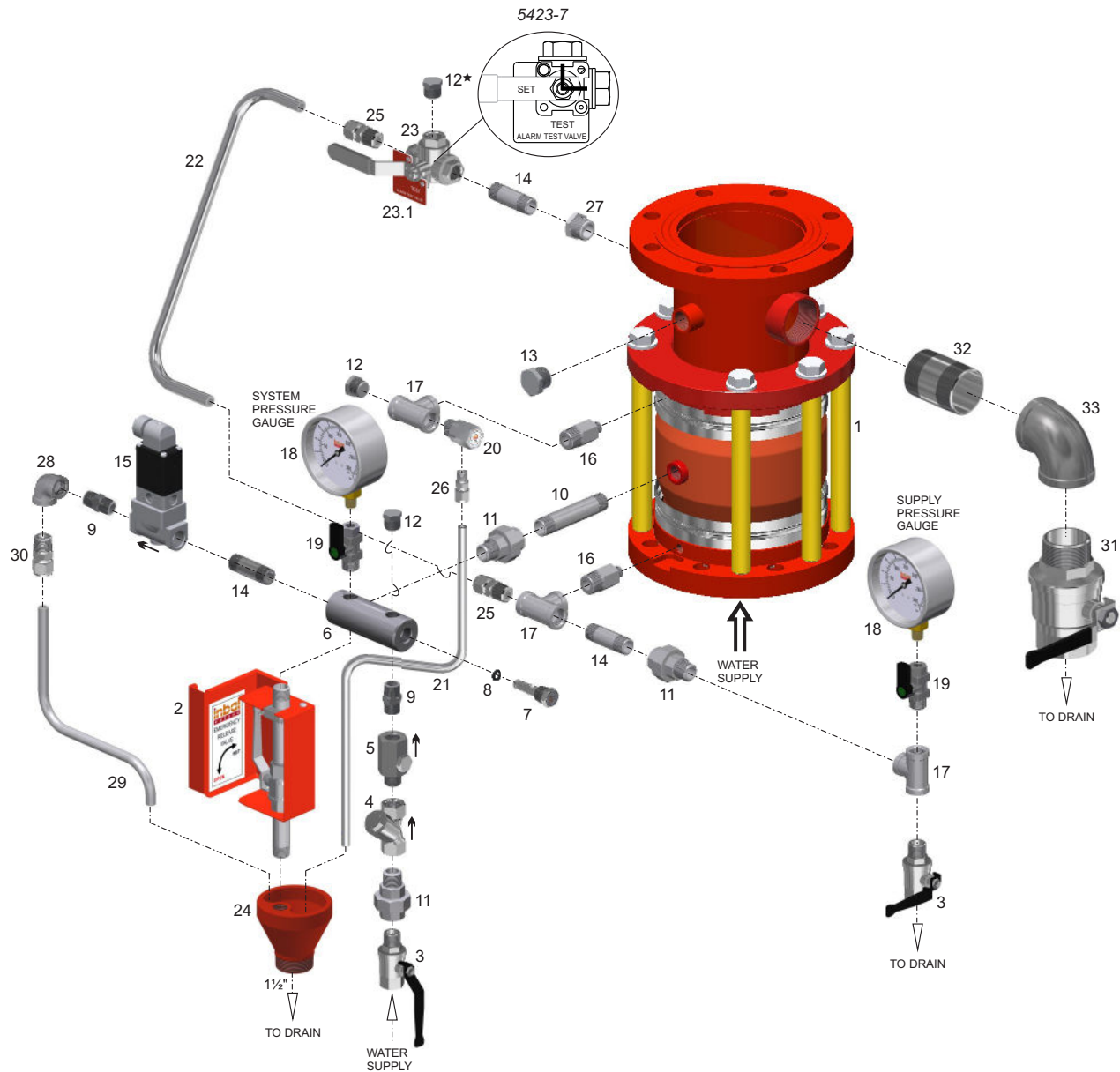

★ Alarm Connection

- The bill of materials is available in the next page.
- The alarm piping should be connected to the common port of the Alarm Test Valve. A Water Motor Alarm requires a  $\frac{3}{4}$ " (20 mm) pipe. For an electric Alarm Pressure Switch - a  $\frac{1}{2}$ " (15 mm) pipe can be used. When a Water Motor Alarm is used, a strainer is required.
- The control trim is supplied fully preassembled.
- When the control trim is ordered in loose components form, the **Inbal** Deluge Valve must be trimmed as shown. Any deviation may affect proper operation.

# Model 733DX-03C06

## FM & UL Trim Chart - Vertical Installation



*Inbal Deluge Valve, Electric Actuation, Remote Resetting, Standard Material Control Trim*

*FM Approved  
UL Listed*

Item	Description	Qty	Material	Cat. No.
1	Inbal Automatic Water Control Valve model 733DX	1	See bulletin F02-03	1733DX01DDSSSS
2	Emergency Release Station model 393-01	1	See bulletin F34-04	239302001002
3	2-Way Ball Valve 1/2", series 351	2	See bulletin F40-08	235102008000
4	Y-Pattern Strainer 1/2", series 31	1	See bulletin F40-03	231006008001
5	Check Valve 1/2", series 371	1	See bulletin F40-12	137102008000
6	Manifold	1	Brass, Ni-Cr plated	322702016000
7	Restriction Orifice model 12-07-02	1	Brass, Ni-Cr plated	312702009001
8	O-Ring 2-109	1	Buna-N	270621090000
9	Hex. Nipple 1/2"	2	St.St.304	212206008001
10	Nipple 1/2", L=4" (102 mm)	1	St.St.304	212206018001
11	Union 1/2" M x F	3	St.St.304	210406008006
12	Plug 1/2"	3	St.St.304	212106008000
13	Plug 3/4"	1	See note (a)	212106012000
14	Nipple 1/2", L=2 1/2" (63 mm)	3	St.St.304	212206016001
15	* Solenoid Valve model 157-42 / 157-93	1		
16	Red. Nipple 1/2" x 1/4", L=2" (51 mm)	2	St.St.304	212306012001
17	Tee 1/2"	3	St.St.304	210106008001
18	Pressure Gauge	2	See bulletin F40-15	213106041002
19	Pressure Gauge Valve 1/2" x 1/4"	2	See bulletin F40-09	235302008001
20	Automatic Drain Valve model 373-08	1	See bulletin F40-13	137302008000
21	Drain Tube 3/8" OD	1	St.St.316	994006060000
22	Alarm Test Tube 1/2" OD	1	St.St.316	994006008000
23	Alarm Test Valve model 347-08-02	1	See bulletin F40-06	234706008000
23.1	Label	1	P.V.C.	
24	Drain Cup	1	Steel, Epoxy coated	397000000000
25	Twin Ferrules Fitting 1/2"NPT x 1/2"OD	2	Brass, Ni-Cr plated	318902007000
26	Tube Fitting 1/4"NPT x 3/8" OD	1	Brass, Ni-Cr plated	314002003000
27	Bushing 3/4"M x 1/2" F	1	See note (a)	211006002001
28	Elbow 1/2"	1	St.St.304	210006008001
29	Drain Tube 1/2" OD	1	St.St.316	994006008000
30	Tube Fitting 1/2"NPT x 1/2"OD	1	Brass, Ni-Cr plated	314002008000
31	(b) 2-Way Ball Valve 3/4", series 351	1	See bulletin F40-08	235102020000
	(c) 2-Way Ball Valve 1 1/2", series 351	1	See bulletin F40-08	235102040000
	(d) 2-Way Ball Valve 2", series 351	1	See bulletin F40-08	235102050000
32	(b) Nipple 3/4", L=3" (80 mm)	1	St.St.304	212206010001
	(c) Nipple 1 1/2", L=3 1/4" (83 mm)	1	St.St.304	212206001000
	(d) Nipple 2", L=3 1/4" (83 mm)	1	St.St.304	212206009001
33	(b) Elbow 3/4"	1	See note (a)	210006012001
	(c) Elbow 1 1/2"	1	See note (a)	210006024001
	(d) Elbow 2"	1	See note (a)	210006032001

Notes: (a) Brass, Ni-Cr plated or Stainless Steel AISI 304.  
(b) For 2" (50 mm) Inbal Valves.  
(c) For 2 1/2" & 3" (65 & 80 mm) Inbal Valves.

(d) For 4"; 6"; 8"; 10" & 12" (100; 150; 200; 250 & 300 mm) Inbal Valves.  
\* UL listed - model 157-42 Cat. No. 215702042001  
FM Approval - model 157-93 Cat. No. 215702093001